

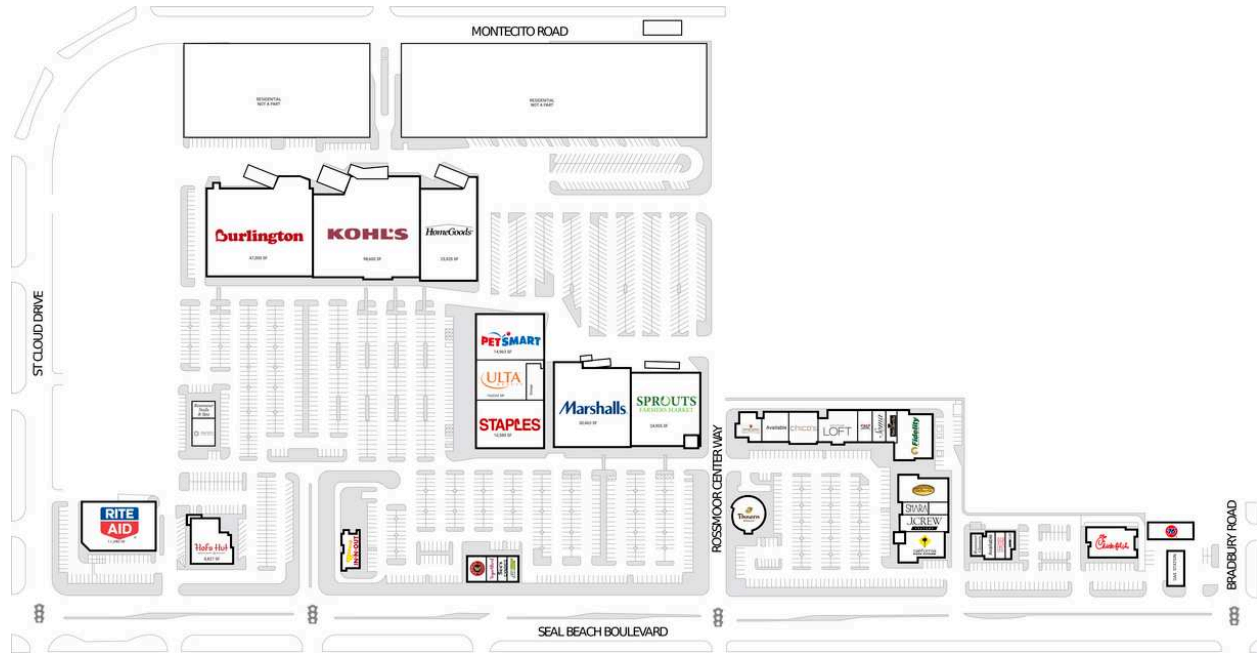

Shops at Rossmoor



| | | | |
|--------------------------------|-----------|---------------------------------|----------|
| M12237 Staples | 16,589 SF | S12151A AVAILABLE | 1,600 SF |
| M12301 Sprouts Farmers Market | 24,905 SF | S12151B Eight Turn Crepe | 1,320 SF |
| M12325 Marshalls | 30,463 SF | S12151C Supercuts | 1,020 SF |
| M12341 PetSmart | 14,963 SF | S12161 Rossmoor Cleaners | 1,200 SF |
| M12343 Home Goods | 25,920 SF | S12171 California Pizza Kitchen | 5,839 SF |
| M12345 Kohl's | 98,600 SF | S12181 J.Crew Factory | 4,259 SF |
| M12347 Burlington Coat Factory | 47,000 SF | S12185 Shara | 1,499 SF |
| P12071 Platinum Energy | 2,788 SF | S12191 Talbots | 5,955 SF |
| P12101 Chick-Fil-A | 4,529 SF | S12201A Fidelity Investments | 7,906 SF |
| P12241 Panera Bread | 4,400 SF | S12203 Peet's Coffee & Tea | 1,730 SF |
| P12365 In-N-Out Burger | 3,750 SF | S12205 Soma | 2,128 SF |
| P12419 Pacific Dental | 5,000 SF | S12207 Prep Kitchen Essentials | 2,134 SF |
| P12489 Hof's Hut Restaurant | 8,500 SF | S12211 Ann Taylor Loft | 5,700 SF |
| P12541 Rite Aid | 17,340 SF | S12217 Chico's | 4,450 SF |

Shops at Rossmoor

| | | | |
|-------------------------|-----------|----------------------|----------|
| S12221 AVAILABLE | 3,698 SF | S12355 See's Candies | 1,340 SF |
| S12235 Fortune Cookies | 3,299 SF | S12357 Yogurtland | 1,200 SF |
| S12339 Ulta | 10,032 SF | S12359 Chipotle | 2,200 SF |
| S12353 Subway | 1,200 SF | | |