

Queen Creek Marketplace

SWC Ellsworth Loop Rd & Rittenhouse Rd



Matt Milinovich
D 480 423 7959
C 602 885 9393
matt.milinovich@avisonyoung.com

James DeCremer
D 480 423 7958
C 602 909 0957
james.decremer@avisonyoung.com

Alec Miller
D 480 423 7955
C 480 531 0369
alec.miller@avisonyoung.com





Dining, shopping, everyday essentials.



The project features a tenant mix of over 35 national retailers including Target, Trader Joe's, Kohl's, TJ Maxx, Ross and Harkins.



...and many more.

The Town of Queen Creek's vision as the center of influence in the southeast Phoenix valley is full of opportunities.



In the past decade, Queen Creek has doubled in population with 68,500 residents in 2021. Growth projection estimate a 44% increase over a 5-year period.



Queen Creek had a record year for single family permits, with a total of 1,985 permits. This was a 21.5% increase over 2019 and nearly 2x the number of single family permits in 2015.



With a median household income of \$105,729 – 78% above the national average – Queen Creek is a prosperous community. The town ranks #3 for households making over six figures in Maricopa County.



With a median age of 34.1 years old, the youngest median age in the East Valley, Queen Creek is thriving with savvy suburbanites and affluent professionals.



Located within 10 minutes of Phoenix-Mesa Gateway Airport and Arizona State University at the Polytechnic Campus, and only 45 minutes from Phoenix Sky Harbor International Airport. Within a 45-minute drive, there is access to a regional workforce of over 1,200,000 people.

For more information, visit queencreek.org

Shop space & PADs available
SWC Ellsworth Loop Rd & Rittenhouse Rd

Economic development plan

The town has identified six strategic areas of focus in marketing and recruiting efforts.



Aerospace & aviation



Health & wellness



Arts, culture & experience



Education



Family/Youth & children activity destinations



Clean & renewable energy & water

Queen Creek is positioned as a **center of influence** in the East Valley, featuring a strategic location, land available for development and a young, highly educated workforce.

Site plan

Shop space & PADs available SWC Ellsworth Loop Rd & Rittenhouse Rd

#	Tenant	Size
Shops B		
B106	Available	2,800 sf
Shops C		
4	Coming available (<i>do not disturb</i>)	2,826 sf
8	Available	4,500 sf
Shops D		
1	Available - <i>Demisable</i>	6,000 sf
Shops E		
1	Available	3,980 sf
PADs		
G	Available PAD / Buildable to	6,000 sf
R	Available PAD / Buildable to	4,300 sf
N	Available PAD / Buildable to	7,153 sf
P	Available PAD / Buildable to	7,475 sf
Summary		
#	Tenant	Size
MJ-1	Available - <i>Demisable</i>	3,000 to 7,000 sf



Site plan

Shop space & PADs available
SWC Ellsworth Loop Rd & Rittenhouse Rd

Shops B

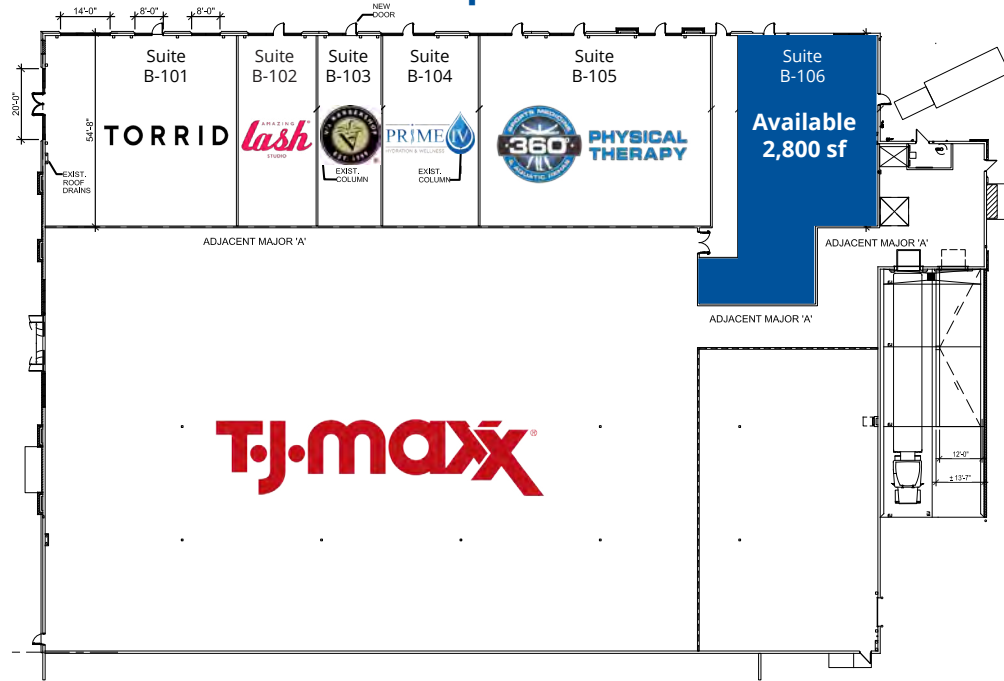

Shops D



Shops C

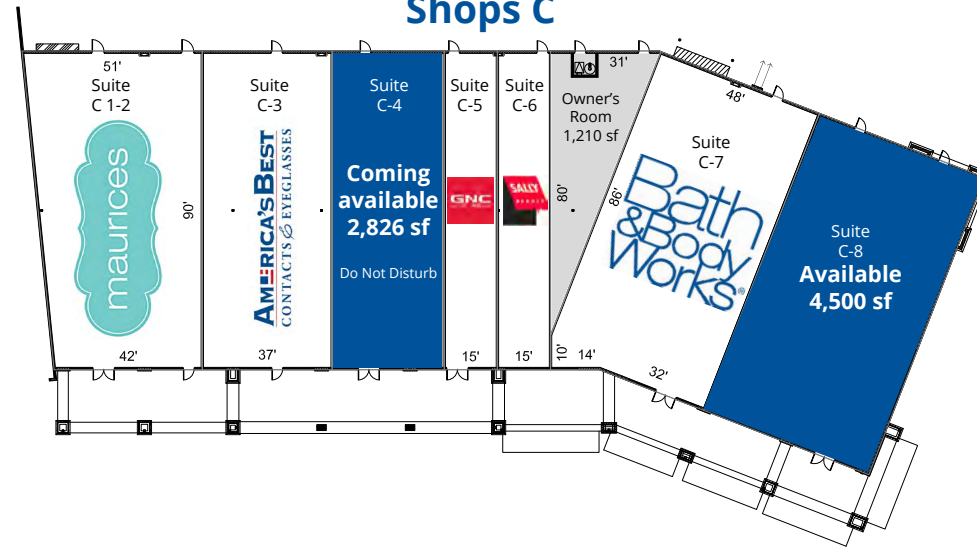

Shops E

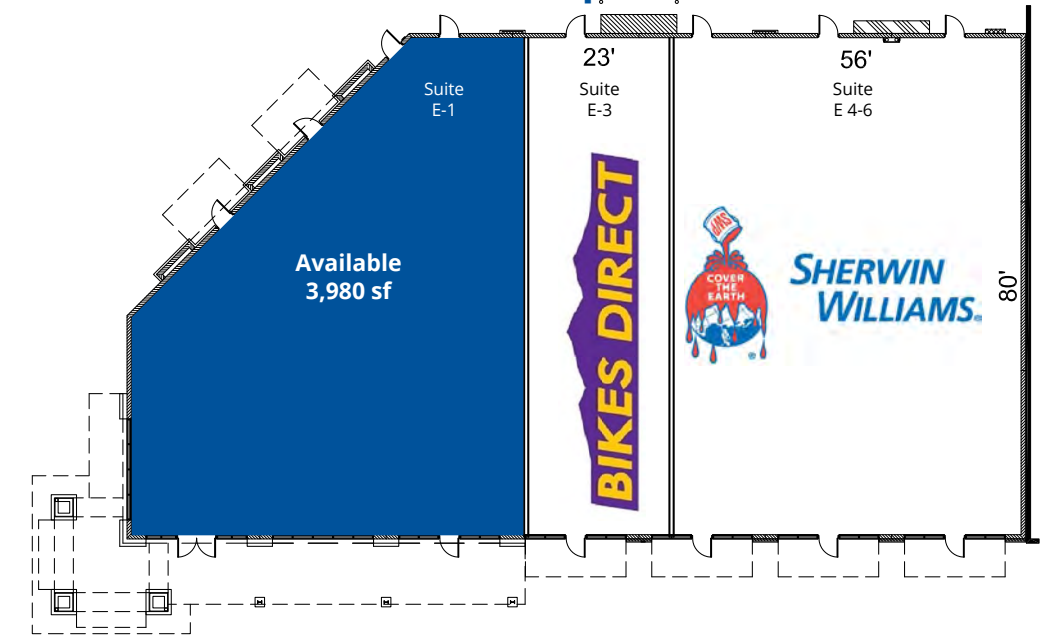

Shops G

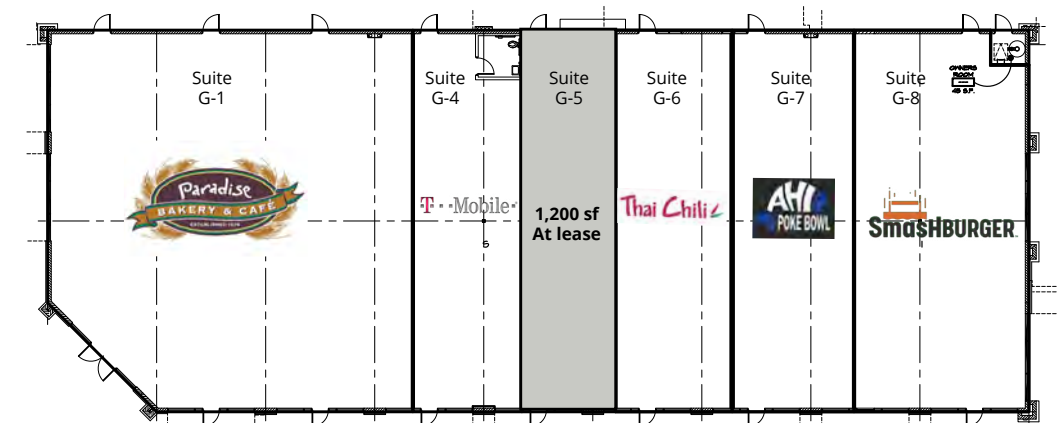



Site aerial

Shop space & PADs available
SWC Ellsworth Loop Rd & Rittenhouse Rd



Demographics

	1-mile	3-miles	5-miles
Population	9,755	48,000	133,968

	1-mile	3-miles	5-miles
Median age	32.8	33.9	34.6

	1-mile	3-miles	5-miles
Daytime employment	3,842	10,374	21,024

	1-mile	3-miles	5-miles
Avg. HH income	\$131,596	\$140,071	\$124,623

	1-mile	3-miles	5-miles
HH units	3,354	15,615	46,263

Traffic counts

	Ellsworth Loop	±52,726 cpd
	Rittenhouse Road	±46,703 cpd

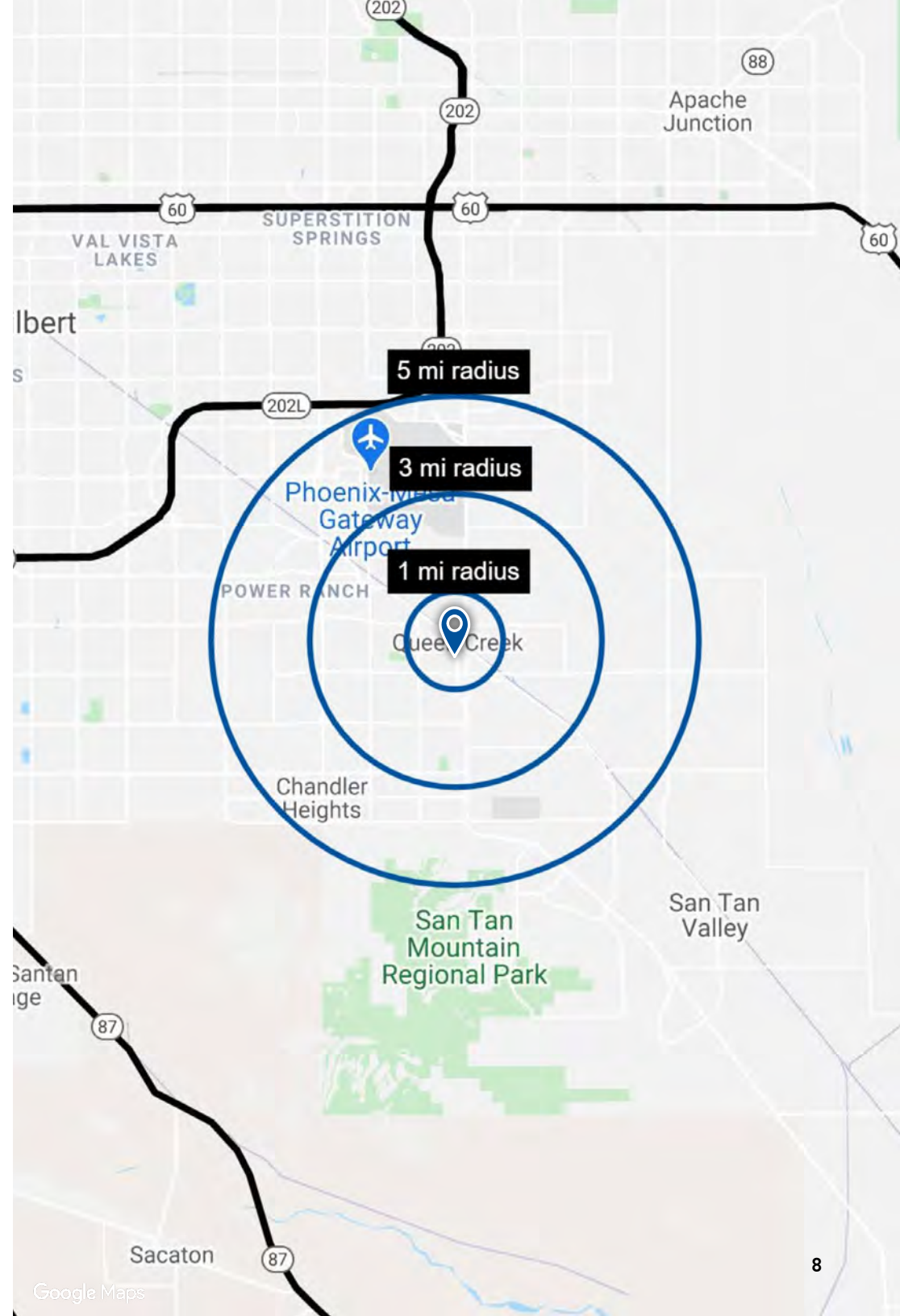

Join us!

Matt Milinovich

D 480 423 7959

C 602 885 9393

matt.milinovich@avisonyoung.com

James DeCremer

D 480 423 7958

C 602 909 0957

james.decremer@avisonyoung.com

Alec Miller

D 480 423 7955

C 480 531 0369

alec.miller@avisonyoung.com



Visit us online
avisonyoung.com

© 2022 Avison Young - Arizona, Ltd. All rights reserved.

E. & O.E.: The information contained herein was obtained from sources which we deem reliable and, while thought to be correct, is not guaranteed by Avison Young.

2720 E Camelback Road | Suite 150 | Phoenix, AZ 85016 | 480 994 8155

